

APPLICATION INSTRUCTIONS

TOOLS NEEDED: Scissors, Tape Measure, Masking tape, Squeegee (provided)

Apply decal to surface when temperature is between 50 - 80 F. Avoid application in windy conditions. Seek another person's assistance before applying a very large graphic.

1. Clean surface thoroughly. Remove any dirt, grease, residue, etc., using alcohol, denatured alcohol or acetone (fiberglass or gel coat only).
2. Tape the decal in the general area to which it will be applied.
3. Measure and adjust location of decal using the baseline and centerline as references (see fig. a).
4. Tape down the center (see fig. b) once the graphic is measured into place.
5. Lift one side of the graphic (see fig. c) and pull the backing paper away from the application tape. Using scissors, cut away that half of the backing paper (see fig. d).
6. Hold the application paper away from the working surface, keeping it slightly slack and squeegee outward from the center (see fig. e). Pull squeegee firmly against surface, hard enough to squeegee out any air from beneath the decal.
7. Discard center strips of masking tape and lift remaining side of graphic. Remove the backing paper (see fig. f) and squeegee outward from the center (see fig. g).
8. Squeegee the entire graphic again, pressing hard.
9. Remove the application tape by pulling it back on itself, rather than pulling it 90° to the surface (see fig. h).
10. Eliminate any bubbles by pricking the vinyl with a sewing needle or pin (see fig. j) and pressing down with a finger or squeegee to expell the air.

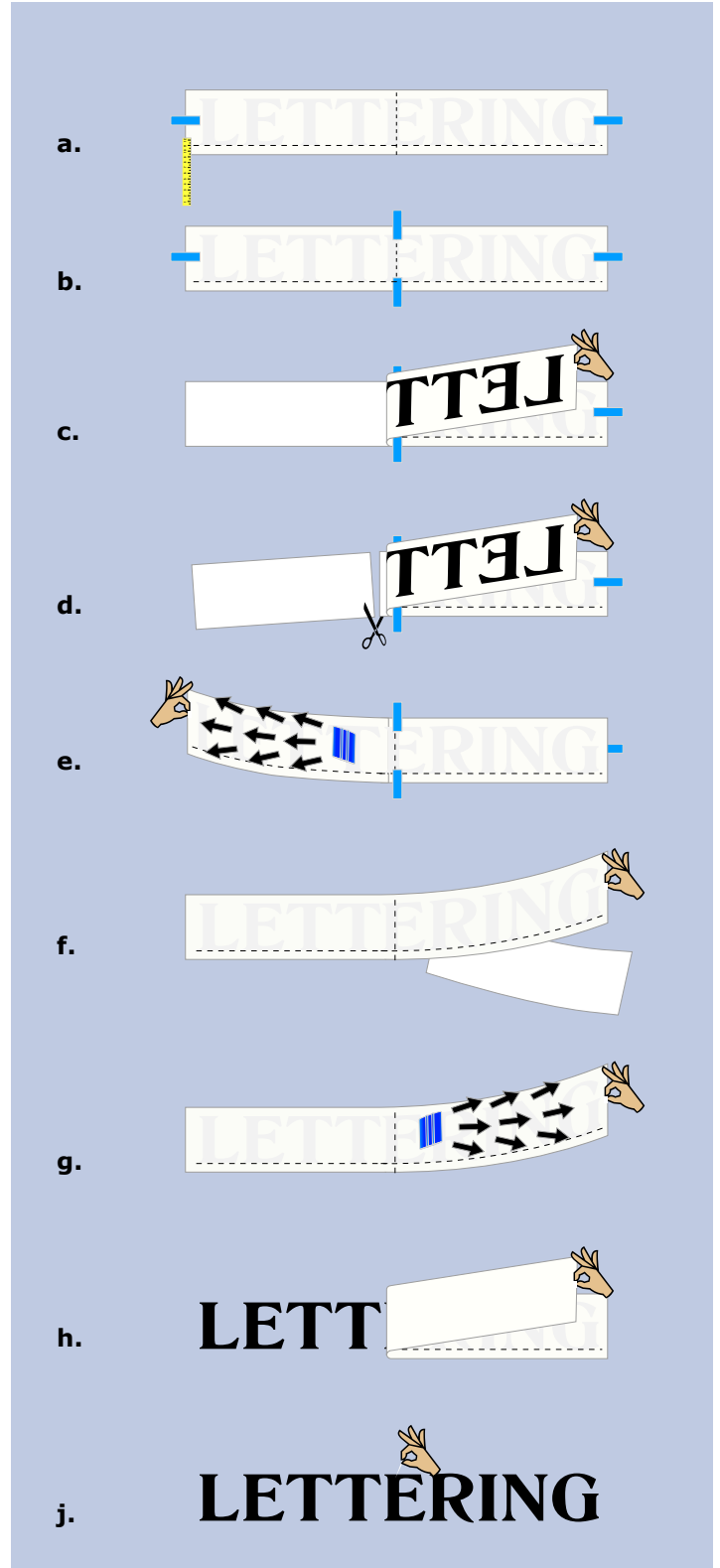

For larger and longer lettering

1. After cleaning the area as described above, tape the decal in the general area to which it will be applied (see *fig. k*).
2. Instead of applying the decal into two parts, you can separate it into four smaller, more manageable parts (see *fig. m*). Then cut the two sections apart (see *fig. n*) and apply each section as described above. Be sure both parts are taped down securely before cutting them apart. Continue to step 3 above.

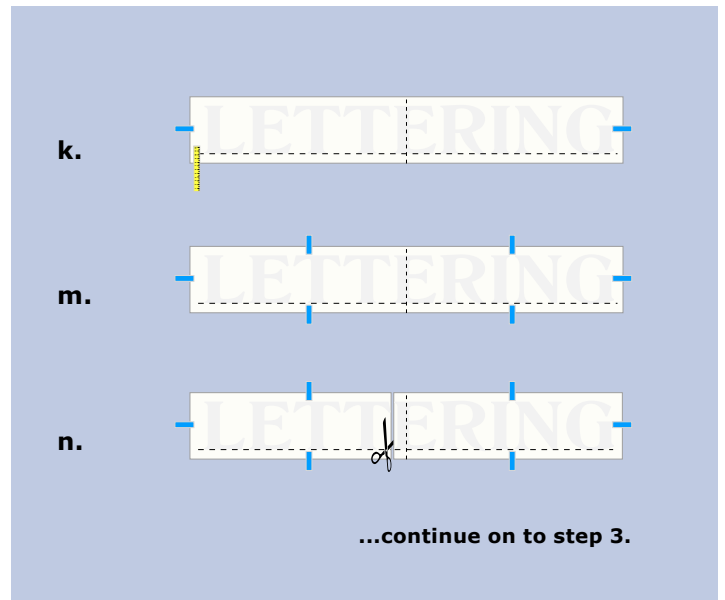

Note: Always wait at least 2 weeks before waxing over a newly applied graphic.